



City of Stuart

CITY DEVELOPMENT DEPARTMENT
121 S.W. FLAGLER AVENUE, STUART FLORIDA 34994
OFFICE: 772/288-5326, FAX: 772/288-5388

Frameall Check List

Job address posted in visible location

Permit and approved plans are on site and accessible

Permit information is correct

Previous required inspections are approved

All inspections required shall have inspection approvals prior to cover and shall be requested by the permit holder

If special inspections are required, have special inspector leave copies of inspection on site and send signed and sealed report to building department

Verify wire size for circuits NEC 310

Min. 2 small appliance circuit for kitchens

Verify outlet spacing

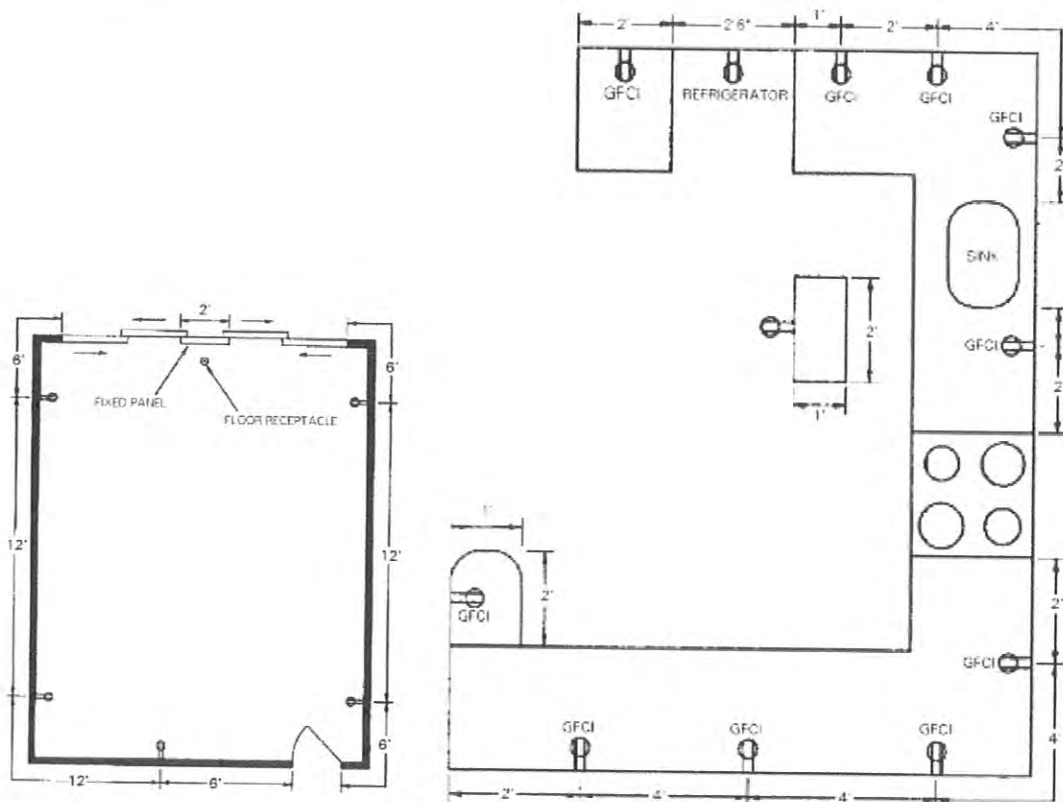

General Information:

This checklist is intended for use to prepare for an inspection. This is only a general list and is not intended to address all possible conditions

Additional information can be obtained from the building department.

Smoke detector all rooms w/door and outside room within 10'. Away from cooking appliance

Verify wire used in wet or underground location NEC 310.10

Verify box and conduit fill NEC 314.16

Nail plates if less than 1.25" from face of framing

Verify listed Fan boxes where required

No unused openings in J-boxes

Fasten NM wire within 12" of box and supported max 4.5'o.c.

Verify required lighting, exterior doors, attic, hall, and stair. Habitable rooms need switched lighting

Min 1- 20 amp dedicated circuit for bathrooms

Dedicated 20 amp circuit for laundry room

Protect NM wire within 7' of attic access

HVAC

Working Space 30" deep to height of unit (min 30"), 3" min clearance around unit
Electrical receptacle within 25" of unit
Means of disconnect within sight or lockable circuit breaker
Switched controlled lighting if in attic
Unit must be labeled with heat strip size and electrical requirements
<i>Attics containing appliances shall be provided with an opening and a clear and unobstructed passageway large enough to allow removal of the largest appliance, but not less than 30 inches (762 mm) high and 22 inches (559 mm) wide and not more than 20 feet (6096 mm) long measured along the centerline of the passageway from the opening to the appliance. The passageway shall have continuous solid flooring</i>
Condensate line min 3/4" and drain to approved location by gravity or UL 508 condensate pump
Ducts penetrating a garage wall or ceiling separating living space to be 26 ga. Or inch (25.4 mm) minimum rigid nonmetallic Class 0 or Class 1 duct board, or other <i>approved</i> material and shall have no openings into the garage.
Bollard or wheel stop required in front of appliance in garage if subject to impact by auto
Duct joints sealed with mastic and mechanically fastened with approved fasteners
Duct supported per manufacture specifications or SMACNA standards
Balanced return air required for all rooms with a door
Return air can't be taken from bathroom, closet, kitchen, garage, unconditioned space, or other dwelling unit
Ducts insulated to R6
Verify combustion air requirements for gas appliances

General Information:

This checklist is intended for use to prepare for an inspection. This is only a general list and is not intended to address all possible conditions

Additional information can obtained from the building department.

Mechanical ventilation required if bathroom doesn't have a operable window
Clothes dryer vent max 35' length unless listed otherwise. 45 bend =2.5', 90 bend =5'
Clothes dryer vent must be smooth metal, joints running in direction of flow. No screen at exterior only flap.

Mechanically fasten vent with max 1/8" protrusion into pipe. Tape joints																																													
Gas appliance connection max 6' flexible line with shutoff ahead of connector																																													
Fireplace installed per manufacture installation instructions and be listed and labeled																																													
A/C condensate lines insulated in unconditioned space																																													
R4 insulation on Freon lines and protected from UV rays.																																													
Locking caps on Freon lines																																													
Float switch ,or Condensate pan and aux drain where damage to building may occur																																													
Plumbing																																													
Water test DWV 5' head min for 15 minutes																																													
Install 18 gauge nail plates if pipes are less than 1 1/4"																																													
Pipe properly supported:																																													
<table border="1"> <thead> <tr> <th>PIPING MATERIAL</th> <th>MAXIMUM HORIZONTAL SPACING (feet)</th> <th>MAXIMUM VERTICAL SPACING (feet)</th> </tr> </thead> <tbody> <tr> <td>ABS pipe</td> <td>4</td> <td>10^b</td> </tr> <tr> <td>Aluminum tubing</td> <td>10</td> <td>15</td> </tr> <tr> <td>Brass pipe</td> <td>10</td> <td>10</td> </tr> <tr> <td>Cast-iron pipe</td> <td>5^a</td> <td>15</td> </tr> <tr> <td>Copper or copper-alloy pipe</td> <td>12</td> <td>10</td> </tr> <tr> <td>Copper or copper-alloy tubing, 1 1/4-inch diameter and smaller</td> <td>6</td> <td>10</td> </tr> <tr> <td>Copper or copper-alloy tubing, 1 1/2-inch diameter and larger</td> <td>10</td> <td>10</td> </tr> <tr> <td>Cross-linked polyethylene (PEX) pipe</td> <td>2.67 (32 inches)</td> <td>10^b</td> </tr> <tr> <td>Cross-linked polyethylene/ aluminum/cross-linked polyethylene (PEX-AL-PEX) pipe</td> <td>2.67 (32 inches)</td> <td>4</td> </tr> <tr> <td>CPVC pipe or tubing, 1 inch and smaller</td> <td>3</td> <td>10^b</td> </tr> <tr> <td>CPVC pipe or tubing, 1 1/4 inches and larger</td> <td>4</td> <td>10^b</td> </tr> <tr> <td>Steel pipe</td> <td>12</td> <td>15</td> </tr> <tr> <td>Lead pipe</td> <td>Continuous</td> <td>4</td> </tr> <tr> <td>Polyethylene/aluminum/</td> <td>2.67</td> <td>4</td> </tr> </tbody> </table>	PIPING MATERIAL	MAXIMUM HORIZONTAL SPACING (feet)	MAXIMUM VERTICAL SPACING (feet)	ABS pipe	4	10 ^b	Aluminum tubing	10	15	Brass pipe	10	10	Cast-iron pipe	5 ^a	15	Copper or copper-alloy pipe	12	10	Copper or copper-alloy tubing, 1 1/4-inch diameter and smaller	6	10	Copper or copper-alloy tubing, 1 1/2-inch diameter and larger	10	10	Cross-linked polyethylene (PEX) pipe	2.67 (32 inches)	10 ^b	Cross-linked polyethylene/ aluminum/cross-linked polyethylene (PEX-AL-PEX) pipe	2.67 (32 inches)	4	CPVC pipe or tubing, 1 inch and smaller	3	10 ^b	CPVC pipe or tubing, 1 1/4 inches and larger	4	10 ^b	Steel pipe	12	15	Lead pipe	Continuous	4	Polyethylene/aluminum/	2.67	4
PIPING MATERIAL	MAXIMUM HORIZONTAL SPACING (feet)	MAXIMUM VERTICAL SPACING (feet)																																											
ABS pipe	4	10 ^b																																											
Aluminum tubing	10	15																																											
Brass pipe	10	10																																											
Cast-iron pipe	5 ^a	15																																											
Copper or copper-alloy pipe	12	10																																											
Copper or copper-alloy tubing, 1 1/4-inch diameter and smaller	6	10																																											
Copper or copper-alloy tubing, 1 1/2-inch diameter and larger	10	10																																											
Cross-linked polyethylene (PEX) pipe	2.67 (32 inches)	10 ^b																																											
Cross-linked polyethylene/ aluminum/cross-linked polyethylene (PEX-AL-PEX) pipe	2.67 (32 inches)	4																																											
CPVC pipe or tubing, 1 inch and smaller	3	10 ^b																																											
CPVC pipe or tubing, 1 1/4 inches and larger	4	10 ^b																																											
Steel pipe	12	15																																											
Lead pipe	Continuous	4																																											
Polyethylene/aluminum/	2.67	4																																											

General Information:

This checklist is intended for use to prepare for an inspection. This is only a general list and is not intended to address all possible conditions

Additional information can be obtained from the building department.

polyethylene (PE-AL-PE) pipe	(32 inches)	
Polyethylene of raised temperature (PE-RT) pipe	2.67 (32 inches)	10 ^b
Polypropylene (PP) pipe or tubing 1 inch and smaller	2.67 (32 inches)	10 ^b
Polypropylene (PP) pipe or tubing, 1 1/4 inches and larger	4	10 ^b
PVC pipe	4	10 ^b
Stainless steel drainage systems	10	10 ^b
<p>a. The maximum horizontal spacing of cast-iron pipe hangers shall be increased to 10 feet where 10-foot lengths of pipe are installed.</p> <p>b. Midstory guide for sizes 2 inches and smaller</p>		
Each trap protected by vent		
Max 30" stand pipe for washer, 24" vertical max for all other fixtures		
Cleanout at base of stack and every 100' for horizontal run. Installed to allow cleaning in direction of flow		
Vents extend min 6" above roof. 10' horizontally away from openings, 4' away from interior firewall		
Air admittance valve: Individual and branch <i>air admittance valves</i> shall be located not less than 4 inches (102 mm) above the horizontal branch drain or <i>fixture drain</i> being vented. Stack-type air admittance valves shall be located not less than 6 inches (152 mm) above the flood level rim of the highest fixture being vented. The <i>air admittance valve</i> shall be located within the maximum <i>developed length</i> permitted for the vent. The <i>air admittance valve</i> shall be installed not less than 6 inches (152 mm) above insulation materials where installed in <i>attics</i> .		
Water or air test 50lb min. No air test on CPVC		
Water-hammer arrestor shall be installed where quick-closing valves are utilized. Water-hammer arrestors shall be installed in accordance with the manufacturer's instructions. Water-hammer arrestors shall conform to ASSE 1010		
Where shower floors and receptors are made water-tight by the application of materials required by Section 417.5.2, the completed liner installation shall be tested. The pipe from the shower drain shall be plugged water tight for the test. The floor and receptor area shall be filled with potable water to a depth of not less than 2 inches (51 mm) measured at the threshold. Where a threshold of at least 2 inches (51 mm) high does not exist, a temporary threshold shall be constructed to retain the test water in the lined floor or receptor area to a level not less than 2 inches (51 mm) deep measured at the threshold. The water shall be retained for a test period of not less than 15 minutes, and there shall not be evidence of leakage.		
Shower floor sloped to drain under liner		
Seats in shower pitched 1/4" per foot		
No fasteners in liner less than 1" above the finished threshold		
Framing		

General Information:

This checklist is intended for use to prepare for an inspection. This is only a general list and is not intended to address all possible conditions

Additional information can be obtained from the building department.

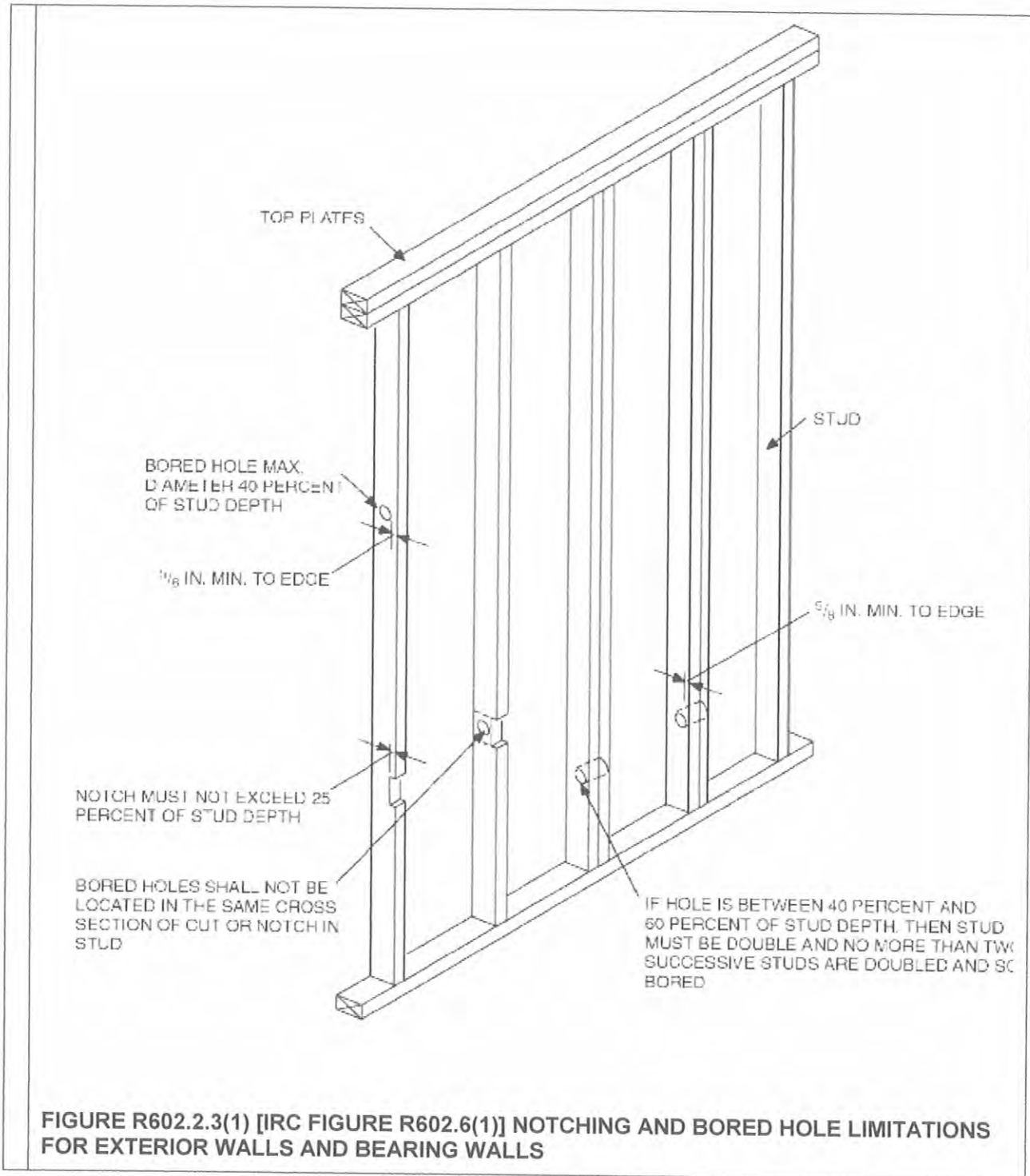

General Information:

This checklist is intended for use to prepare for an inspection. This is only a general list and is not intended to address all possible conditions

Additional information can be obtained from the building department.